

## DRAGFLOW HY85-160 HYDRAULIC SUBMERSIBLE PUMP

### Hydraulic pump *HY85/160*

Technical specifications:		
Model:	A	B
Capacity:	250 m <sup>3</sup> / h	500 m <sup>3</sup> / h
Head:	51 m	36 m
Weight:	820 Kg	840 Kg
Cross section:	∅ 60 mm	∅ 60 mm
Impeller:	3 vaned closed / ∅ 440 mm	3 vaned closed / ∅ 440 mm
Bore:	∅ 200 mm	∅ 250 mm

Motor:		
Speed:	1450 rpm	1450 rpm
Output:	115 Kw (156 HP)	115 Kw (156 HP)
Need of oil:	240 L/ min	240 L/ min
Oil pressure:	300 bar	300 bar
Motor displacement:	160 c. c.	160 c. c.

**Materials:**  
 Main body: spheroidal cast iron GS500.  
 Motor housing: cast iron GS5.  
 Wearing parts: high chrom.  
 Main shaft: austempering NiCrMo4 Steel.

**Seals:**  
 Seals motor zone: n° 2 rubber lip seals.  
 Seals impeller zone: n° 1 polyurethane V-RING, n° 3 rubber lip seals, n° 2 PTFE lip seals with stainless steel spring ( alternate ).



**Performance curve:**

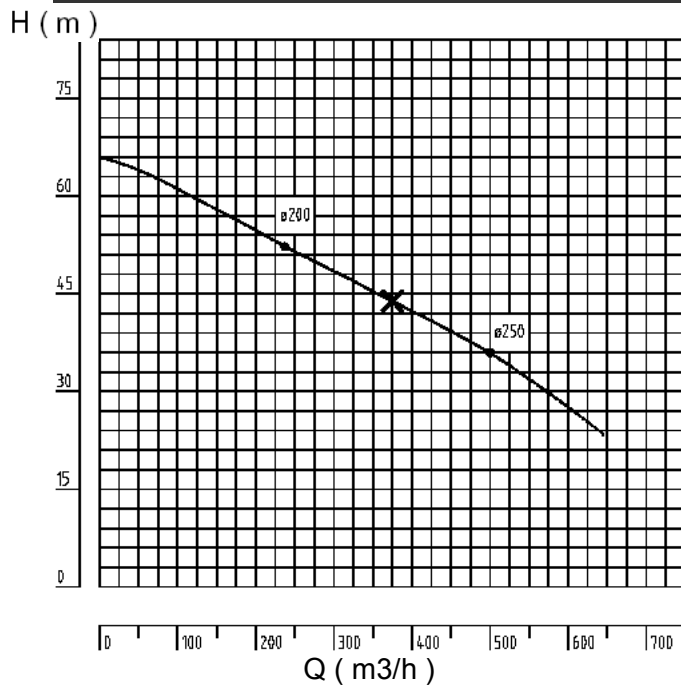

**Dimensions:**

A (mm)	1390
B (mm)	460
C (mm)	548
D (mm)	747
E (mm)	334
F (mm)	362
G (mm)	428
H1 (mm)	290
H2 (mm)	197
l (mm)	933

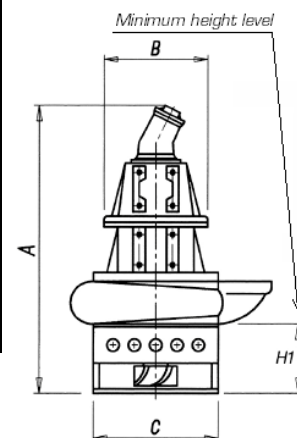
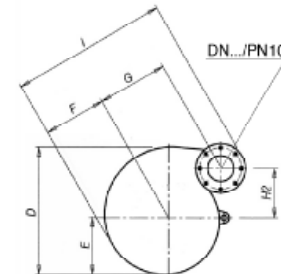

Dragflow srl - Via Spagna 13 - 37069 Villafranca (VR) Italy  
 tel. +39.045.6304521 - fax +39.045.6335758  
 info@dragflow.it - www.dragflow.it

